

| A | B | C | TOOL # |
|------|------|------|--------|
| 1.00 | .107 | .500 | C-104 |
| .700 | .130 | .500 | C-102 |
| .658 | .170 | .074 | B-321 |
| .500 | .100 | .320 | B-322 |
| .446 | .269 | .394 | B-529 |
| .394 | .177 | .118 | B-269 |
| .320 | .200 | .100 | B-609 |
| .250 | .113 | .080 | B-335 |
| .220 | .154 | .100 | B-323 |
| .220 | .160 | .100 | B-324 |
| .200 | .130 | .130 | B-325 |

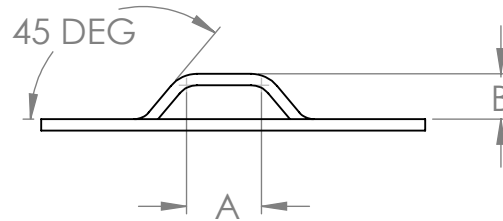
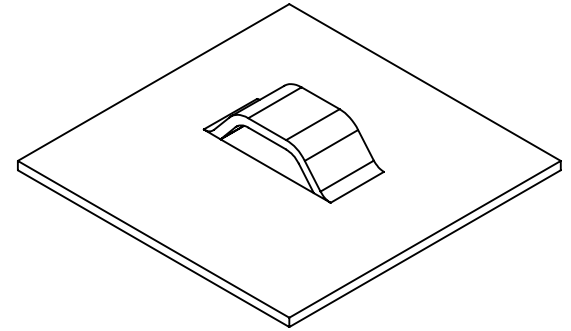
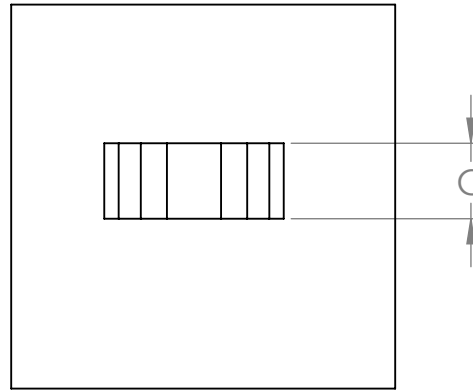

NOTES:

1. MAXIMUM MATERIAL THICKNESS IS .080.

Courtesy of
Data Metalcraft, Inc.
RESOURCE CENTER
www.datametal.com

DATA
METALCRAFT
INC.

PROPRIETARY AND CONFIDENTIAL

THE INFORMATION CONTAINED IN THIS DRAWING IS THE SOLE PROPERTY OF DATA METALCRAFT INC. ANY REPRODUCTION IN PART OR AS A WHOLE WITHOUT THE WRITTEN PERMISSION OF DATA METALCRAFT INC. IS PROHIBITED.

CATEGORY:

| SIZE | TITLE: | REV |
|----------|---------------------|----------|
| A | BRIDGE LANCE | A |